

TEST REPORT NO : MUMOT212200759 **DATE** : 07.06.2021 **LOCATION** : MUMBAI
Page : 1 of 8

Customer : PLAYQID. Date of Receiving : 03.06.2021
Address : 201, 2nd Floor, Agrawal Arcade, opp central Mall, Nr. Ambawadi Circle, Ellisbridge, Ahmedabad-380006 Date of Test Start : 03.06.2021
 Date of test Completion : 07.06.2021
 Date of Reporting : 07.06.2021

Contact Person : Navya Bhansali
Contact Details : 7203036095
Email : info@playqid.com

Sample was submitted by supplier and all test(s) performed as per current standards edition or unless otherwise requested. Identification of submitted sample based on information given by the client is as under: The test results stated in this report relate only to the item(s) tested.

Sample Description : HEROIC KNIGHTS-THE CASTLE SAVIOUR.
Item No. : -
Style No. : -
Colour : Multi
Age Grade : 3+
Item Code : -
Month & Year of Mfg : May 2021
Country of Origin : India
Sample Condition : Good

Overall Status
PASS

Summary of Test Results				
Sr. No.	Test Parameters	Test Standards	Conclusion	Remark
01	Mechanical and Physical Properties	EN 71-1:2014 + A1 : 2018	P	-
02	Migration of certain Elements	EN71 Part 3 : 2019	P	-
Notes P = Pass, F= Fail, NA = Not Applicable, NC=No Comments (See Results)				

~~~~~For Further Details, Please Refer to the following Page(s)~~~~~

**Authorized signatory**



**CHNADRAKANT PALEKAR**  
**(Technical Manager)**



**Verified By**

- TESTED SAMPLE NOT DRAWN BY THE LABORATORY.
- RESULTS RELATE ONLY TO THE SAMPLE TESTED.
- THE TEST REPORT SHALL NOT BE REPRODUCED WITHOUT PRIOR WRITTEN APPROVAL OF THE LABORATORY.
- THE REPORT IS FOR YOUR PRIVATE USE ONLY AND SHOULD NOT BE USED FOR LITIGATION PURPOSE.
- TESTED SAMPLES WILL BE RETAINED FOR 30 DAYS AFTER ISSUE OF TEST REPORT UNLESS OTHERWISE AGREED WITH THE CUSTOMER.

## Testtex India Laboratories Pvt. Ltd.

H.O. & CENTRAL LABORATORY:  
 301-304, Premson's Indl. Estate, caves road  
 Jogeshwari (E), Mumbai- 400 060.  
 Ph: +91 - 22 - 28259190 / 30104500  
 Fax: +91 - 22 - 28265116  
 Email Id : [labsindia@testtex.com](mailto:labsindia@testtex.com)

Tirupur : +91-421-2228588,4218588      [labsindiatirupur@testtex.com](mailto:labsindiatirupur@testtex.com)  
 Noida : +91-120-4359190      [labsindianoida@testtex.com](mailto:labsindianoida@testtex.com)  
 Ahmedabad : +91-9601089097      [labsindiaahmedabad@testtex.com](mailto:labsindiaahmedabad@testtex.com)  
 Hongkong : +852-31623191      [labhk@testtex.com](mailto:labhk@testtex.com)

[www.testtex.com](http://www.testtex.com)

Tested samples will be retained for 30 days after issue of test report unless otherwise agreed with the customer.  
 Testing Textiles, Leather Products, Footwear, Water, Food, Packaging Material, Construction Materials & Consumer Goods

**TTI/REC30/TR/TOYS**

TEST REPORT NO : MUMOT212200759 DATE : 07.06.2021 LOCATION : MUMBAI  
Page : 2 of 8

**TEST REPORT**

**Tested components:**

- A. Puzzle
- B. Plastic Black

As per European Standard on Safety of toys EN71-1:2014 + A1 : 2018

**1. The submitted samples were undergone the following abuse tests:**

| Test name        | Clause name | Test Result                                                   |
|------------------|-------------|---------------------------------------------------------------|
| Torque test      | 8.3         | Withstand @ 0.34 N                                            |
| Tension Test     | 8.4.2.1     | Withstand @ 90 N                                              |
| Drop test        | 8.5         | <b>Magnify Glass: Doesn't withstand*</b><br>Puzzle: Withstand |
| Impact test      | 8.7         | Withstand                                                     |
| Compression test | 8.8         | Withstand @ 110 N                                             |

\*Since the product (Age grade is 3+), and safety warning label is present hence Drop test for (magnify glass) is pass

| Clause | Description                                                        | Result |
|--------|--------------------------------------------------------------------|--------|
| 4.1    | Material cleanliness                                               | P      |
| 4.2    | Assembly                                                           | P      |
| 4.3    | Flexible plastic sheeting                                          | NA     |
| 4.4    | Toy bags                                                           | NA     |
| 4.5    | Glass                                                              | P      |
| 4.6    | Expanding materials                                                | NA     |
| 4.7    | Edges                                                              | P      |
| 4.8    | Points and metallic wires                                          | P      |
| 4.9    | Protruding parts                                                   | NA     |
| 4.10   | Parts moving against each other                                    | NA     |
| 4.11   | Mouth-actuated toys and other toys intended to be put in the mouth | NA     |
| 4.12   | Balloons                                                           | NA     |
| 4.13   | Cords of toy kites and other flying toys                           | NA     |
| 4.14   | Enclosures                                                         | NA     |
| 4.15   | Toys intended to bear the mass of a child                          | NA     |
| 4.16   | Heavy immobile toys                                                | NA     |
| 4.17   | Projectiles                                                        | NA     |

**Testtex India Laboratories Pvt. Ltd.**

H.O. & CENTRAL LABORATORY:  
301-304, Premson's Indl. Estate, caves road  
Jogeshwari (E), Mumbai- 400 060.  
Ph: +91 - 22 - 28259190 / 30104500  
Fax: +91 - 22 - 28265116  
Email Id : [labsindia@testtex.com](mailto:labsindia@testtex.com)

Tirupur : +91-421-2228588,4218588 [labsindiatirupur@testtex.com](mailto:labsindiatirupur@testtex.com)  
Noida : +91-120-4359190 [labsindianoida@testtex.com](mailto:labsindianoida@testtex.com)  
Ahmedabad : +91-9601089097 [labsindiaahmedabad@testtex.com](mailto:labsindiaahmedabad@testtex.com)  
Hongkong : +852-31623191 [labhk@testtex.com](mailto:labhk@testtex.com)

[www.testtex.com](http://www.testtex.com)

Tested samples will be retained for 30 days after issue of test report unless otherwise agreed with the customer.  
Testing Textiles, Leather Products, Footwear, Water, Food, Packaging Material, Construction Materials & Consumer Goods

**TTI/REC30/TR/TOYS**

TEST REPORT NO : MUMOT212200759 DATE : 07.06.2021 LOCATION : MUMBAI  
Page : 3 of 8

| Clause | Description                                                                          | Result |
|--------|--------------------------------------------------------------------------------------|--------|
| 4.18   | Aquatic toys and inflatable toys                                                     | NA     |
| 4.19   | Percussion caps specifically designed for use in toys and toys using percussion caps | NA     |
| 4.20   | Acoustics                                                                            | NA     |
| 4.21   | Toys containing a non-electrical heat source                                         | NA     |
| 4.22   | Small balls                                                                          | NA     |
| 4.23   | Magnets                                                                              | NA     |
| 4.24   | Yo-yo balls                                                                          | NA     |
| 4.25   | Toys attached to food                                                                | NA     |
| 4.26   | Toy Disguise Costumes                                                                | NA     |
| 4.27   | Flying toys                                                                          | NA     |
| 5      | Toys intended for children under 36months                                            | NA     |
| 5.1    | General requirements                                                                 | NA     |
| 5.2    | Soft-filled toys and soft-filled parts of a toy                                      | NA     |
| 5.3    | Plastic sheeting                                                                     | NA     |
| 5.4    | Cords, chains and electrical cables in toys                                          | NA     |
| 5.5    | Liquid-filled toys                                                                   | NA     |
| 5.6    | Speed limitation of electrically-driven ride-on toys                                 | NA     |
| 5.7    | Glass and porcelain                                                                  | NA     |
| 5.8    | Shape and size of certain toys                                                       | NA     |
| 5.9    | Toys comprising monofilament fibers                                                  | NA     |
| 5.10   | Small balls                                                                          | NA     |
| 5.11   | Play figures                                                                         | NA     |
| 5.12   | Hemispheric shaped toys                                                              | NA     |

## Testtex India Laboratories Pvt. Ltd.

H.O. & CENTRAL LABORATORY:

301-304, Premson's Indl. Estate, caves road

Jogeshwari (E), Mumbai- 400 060.

Ph: +91 - 22 - 28259190 / 30104500

Fax: +91 - 22 - 28265116

Email Id : [labsindia@testtex.com](mailto:labsindia@testtex.com)

Tirupur : +91-421-2228588,4218588

Noida : +91-120-4359190

Ahmedabad : +91-9601089097

Hongkong : +852-31623191

[labsindiatirupur@testtex.com](mailto:labsindiatirupur@testtex.com)

[labsindianoida@testtex.com](mailto:labsindianoida@testtex.com)

[labsindiaahmedabad@testtex.com](mailto:labsindiaahmedabad@testtex.com)

[labhk@testtex.com](mailto:labhk@testtex.com)

[www.testtex.com](http://www.testtex.com)

Tested samples will be retained for 30 days after issue of test report unless otherwise agreed with the customer.  
Testing Textiles, Leather Products, Footwear, Water, Food, Packaging Material, Construction Materials & Consumer Goods

TTI/REC30/TR/TOYS

TEST REPORT NO : MUMOT212200759 DATE : 07.06.2021 LOCATION : MUMBAI  
Page : 4 of 8

| Clause | Description                                                                              | Test Result |
|--------|------------------------------------------------------------------------------------------|-------------|
| 5.13   | Suction cups                                                                             | NA          |
| 5.14   | Straps intended to be worn fully or partially around the neck                            | NA          |
| 5.15   | Sledges with cords for pulling                                                           | NA          |
| 6.0    | Packaging                                                                                | NA          |
| 7.0    | Warnings, markings and instructions for use                                              | P           |
| 7.1    | General                                                                                  | P           |
| 7.2    | Toys not intended for children under 36months                                            | NA          |
| 7.3    | Latex balloon                                                                            | NA          |
| 7.4    | Aquatic toys                                                                             | NA          |
| 7.5    | Function toys                                                                            | NA          |
| 7.6    | Hazardous sharp functional edges and points                                              | NA          |
| 7.7    | Projectiles toys                                                                         | NA          |
| 7.8    | Imitation protective masks and helmets                                                   | NA          |
| 7.9    | Toy kites                                                                                | NA          |
| 7.10   | Roller skates, inline skates, skateboards and certain other ride-on toys                 | NA          |
| 7.11   | Toys intended to be attached to or strung across a cradle, cot, or perambulator          | NA          |
| 7.12   | Liquid filled teethers                                                                   | NA          |
| 7.13   | Percussion caps specifically designed for use in toys                                    | NA          |
| 7.14   | Acoustics                                                                                | NA          |
| 7.15   | Toy bicycles                                                                             | NA          |
| 7.16   | Toys intended to bear the mass of a child                                                | NA          |
| 7.17   | Toys comprising monofilament fibers                                                      | NA          |
| 7.18   | Toy scooters                                                                             | NA          |
| 7.19   | Rocking horses and similar toys                                                          | NA          |
| 7.20   | Magnetic/electrical experimental sets                                                    | NA          |
| 7.21   | Toys with electrical cables exceeding 300 mm in length                                   | NA          |
| 7.22   | Toys with cords or chains intended for children of 18months and over but under 36 months | NA          |

## Testtex India Laboratories Pvt. Ltd.

H.O. & CENTRAL LABORATORY:

301-304, Premson's Indl. Estate, caves road  
Jogeshwari (E), Mumbai- 400 060.

Ph: +91 - 22 - 28259190 / 30104500

Fax: +91 - 22 - 28265116

Email Id : [labsindia@testtex.com](mailto:labsindia@testtex.com)

Tirupur : +91-421-2228588,4218588

Noida : +91-120-4359190

Ahmedabad : +91-9601089097

Hongkong : +852-31623191

[labsindiatirupur@testtex.com](mailto:labsindiatirupur@testtex.com)

[labsindianoida@testtex.com](mailto:labsindianoida@testtex.com)

[labsindiaahmedabad@testtex.com](mailto:labsindiaahmedabad@testtex.com)

[labhk@testtex.com](mailto:labhk@testtex.com)

[www.testtex.com](http://www.testtex.com)

Tested samples will be retained for 30 days after issue of test report unless otherwise agreed with the customer.  
Testing Textiles, Leather Products, Footwear, Water, Food, Packaging Material, Construction Materials & Consumer Goods

TTI/REC30/TR/TOYS

TEST REPORT NO : MUMOT212200759 DATE : 07.06.2021 LOCATION : MUMBAI  
Page : 5 of 8

| Clause | Description                                                   | Test Result |
|--------|---------------------------------------------------------------|-------------|
| 7.23   | Toys intended to be attached to a cradle, cot or perambulator | NA          |
| 7.24   | Sledges with cords for pulling                                | NA          |
| 7.25   | Flying toys                                                   | NA          |
| 7.26   | Improvised projectiles                                        | NA          |

Remark: P = Pass NA = Not applicable

## 2.Test Conducted: Migration of certain elements as specified in European Standard on Safety of Toys ( EN71 Part 3:2019 )

| Element                | Result ( mg/kg ) |               | MDL<br>mg/kg | Requirement ( mg/kg )<br>Category (III) |
|------------------------|------------------|---------------|--------------|-----------------------------------------|
|                        | Component : A    | Component : B |              |                                         |
| Aluminum (Al)          | n.d              | n.d           | 25           | 70000                                   |
| Antimony (Sb)          | n.d              | n.d           | 5            | 560                                     |
| Arsenic (As)           | n.d              | n.d           | 0.5          | 47                                      |
| Barium (Ba)            | n.d              | n.d           | 50           | 18750                                   |
| Boron (B)              | n.d              | n.d           | 50           | 15000                                   |
| Cadmium (Cd)           | n.d              | n.d           | 0.1          | 17                                      |
| Chromium (Cr)          | n.d              | n.d           | 0.2          | --                                      |
| Chromium - III<br>(Cr) | n.d              | n.d           | 0.2          | 460                                     |
| Chromium - VI (Cr)     | n.d              | n.d           | 0.02         | 0.053                                   |
| Cobalt (Co)            | n.d              | n.d           | 1.0          | 130                                     |
| Copper (Cu)            | n.d              | n.d           | 25           | 7700                                    |
| Lead (Pb)              | n.d              | n.d           | 0.2          | 23                                      |
| Manganese (Mn)         | n.d              | n.d           | 50           | 15000                                   |
| Mercury (Hg)           | n.d              | n.d           | 0.5          | 94                                      |
| Nickel (Ni)            | n.d              | n.d           | 1.0          | 930                                     |
| Selenium (Se)          | n.d              | n.d           | 5.0          | 460                                     |
| Strontium (Sr)         | n.d              | n.d           | 25           | 56000                                   |
| Tin (Sn)               | n.d              | n.d           | 1.0          | 180000                                  |
| Organic tin            | n.d              | n.d           | 0.1          | 12                                      |
| Zinc (Zn )             | n.d              | n.d           | 25           | 46000                                   |

### Remarks:

mg/kg = milligram per kilogram  
MDL = Method Detection Limit  
ND = Not Detected, less than MDL

## Testtex India Laboratories Pvt. Ltd.

H.O. & CENTRAL LABORATORY:  
301-304, Premson's Indl. Estate, caves road  
Jogeshwari (E), Mumbai- 400 060.  
Ph: +91 - 22 - 28259190 / 30104500  
Fax: +91 - 22 - 28265116  
Email Id : [labsindia@testtex.com](mailto:labsindia@testtex.com)

Tirupur : +91-421-2228588,4218588 [labsindiaturupur@testtex.com](mailto:labsindiaturupur@testtex.com)  
Noida : +91-120-4359190 [labsindianoida@testtex.com](mailto:labsindianoida@testtex.com)  
Ahmedabad : +91-9601089097 [labsindiaahmedabad@testtex.com](mailto:labsindiaahmedabad@testtex.com)  
Hongkong : +852-31623191 [labhk@testtex.com](mailto:labhk@testtex.com)

[www.testtex.com](http://www.testtex.com)

Tested samples will be retained for 30 days after issue of test report unless otherwise agreed with the customer.  
Testing Textiles, Leather Products, Footwear, Water, Food, Packaging Material, Construction Materials & Consumer Goods

TTI/REC30/TR/TOYS

TEST REPORT NO : MUMOT212200759 DATE : 07.06.2021 LOCATION : MUMBAI  
Page : 6 of 8

Table for Determine category

| Toy Material                                                                                                                                                                       | Category I | Category II | Category III |
|------------------------------------------------------------------------------------------------------------------------------------------------------------------------------------|------------|-------------|--------------|
| Coating of paints , varnishes , lacquers, printing inks, polymer, foam & similar coatings                                                                                          |            |             | X            |
| Polymeric and similar materials, including laminates, whether textile reinforced or not, but excluding other textiles                                                              |            |             | X            |
| Paper and paper board                                                                                                                                                              |            |             | X            |
| Textile , whether natural or synthetic                                                                                                                                             |            |             | X            |
| Glass , ceramic, metallic materials                                                                                                                                                |            |             | X            |
| Wood , fiber board, hard board ,bone, leather and solid materials                                                                                                                  |            |             | X            |
| Compressed paint tablets, materials intended to leave a trace or similar materials in solid form appearing as such in the toy (e.g the cores of colouring pencils ,chalk, crayons) | X          |             | X            |
| Pliable modeling materials, including modeling clays and plaster                                                                                                                   | X          |             |              |
| Liquid paints , including finger paints, varnishes , lacquers, liquid ink in pens and similar materials in liquid form appearing as such in the toy(e.g slimes, bubble solution)   |            | X           |              |
| Glue sticks                                                                                                                                                                        |            | X           |              |

Migration limits from toys materials

| Elements            | Permissible Limit, mg/kg (Max) |            |              |
|---------------------|--------------------------------|------------|--------------|
|                     | Category I                     | Category I | Category III |
| Aluminum (Al)       | 5625                           | 1406       | 70 000       |
| Antimony (Sb)       | 45                             | 11.3       | 560          |
| Arsenic (As)        | 3.8                            | 0.9        | 47           |
| Barium (Ba)         | 1500                           | 375        | 18750        |
| Boron (B)           | 1200                           | 300        | 15000        |
| Cadmium (Cd)        | 1.3                            | 0.3        | 17           |
| Chromium (Cr)       | --                             | --         | --           |
| Chromium – III (Cr) | 37.5                           | 9.4        | 460          |
| Chromium – VI (Cr)  | 0.02                           | 0.005      | 0.2/ 0.053   |
| Cobalt (Co)         | 10.5                           | 2.6        | 130          |
| Copper (Cu)         | 622.5                          | 156        | 7700         |
| Lead (Pb)           | 2.0                            | 0.5        | 23           |
| Manganese (Mn)      | 1200                           | 300        | 15000        |
| Mercury (Hg)        | 7.5                            | 1.9        | 94           |
| Nickel (Ni)         | 75                             | 18.8       | 930          |
| Selenium (Se)       | 37.5                           | 9.4        | 460          |
| Strontium (Sr)      | 4500                           | 1125       | 56000        |
| Tin (Sn)            | 15000                          | 3750       | 180000       |
| Organic tin         | 0.9                            | 0.2        | 12           |
| Zinc (Zn)           | 3750                           | 938        | 46000        |

## Testtex India Laboratories Pvt. Ltd.

H.O. & CENTRAL LABORATORY:

301-304, Premson's Indl. Estate, caves road  
Jogeshwari (E), Mumbai- 400 060.

Ph: +91 - 22 - 28259190 / 30104500

Fax: +91 - 22 - 28265116

Email Id : [labsindia@testtex.com](mailto:labsindia@testtex.com)

Tirupur : +91-421-2228588,4218588

Noida : +91-120-4359190

Ahmedabad : +91-9601089097

Hongkong : +852-31623191

[labsindiaturipur@testtex.com](mailto:labsindiaturipur@testtex.com)

[labsindianoida@testtex.com](mailto:labsindianoida@testtex.com)

[labsindiaahmedabad@testtex.com](mailto:labsindiaahmedabad@testtex.com)

[labhk@testtex.com](mailto:labhk@testtex.com)

[www.testtex.com](http://www.testtex.com)

Tested samples will be retained for 30 days after issue of test report unless otherwise agreed with the customer.  
Testing Textiles, Leather Products, Footwear, Water, Food, Packaging Material, Construction Materials & Consumer Goods

TTI/REC30/TR/TOYS

TEST REPORT NO : MUMOT212200759 DATE : 07.06.2021 LOCATION : MUMBAI  
Page : 7 of 8

**Note:**

- 1) Chromium (Cr) content can be used for screen test for test for hexavalent chromium and trivalent chromium analysis and to show compliance with the requirement of test method.
- 2) Chromium(Cr) = Hexavalent Cr(VI) + Trivalent Cr(III), where the chromium content exceeded the limits of hexavalent chromium was further analyzed and trivalent chromium content was calculated using the formula.
- 3) Tin (Sn) content can be used for screen test for organic tins analysis to show compliance with the requirement of test method.
- 4) The migration of organic tin is expressed as Tributyltin (TBTP). Where the tin content exceeded the limit of organic tin, ten organic tins listed in table were determined by GC-MS and Organic tins tested are as under  
*Methyl tin (MeTO), Butyl tin (BuT), Dibutyl tin (DBT), Tributyl tin (TBT), Tetrabutyl tin (TeBT), n-Octyl tin (MOT), Di-n-octyl tin (DOT0), Di-n-propyl tin (DProT), Diphenyl tin (DPHT), Triphenyl tin (TPhT)*

## Testtex India Laboratories Pvt. Ltd.

H.O. & CENTRAL LABORATORY:

301-304, Premson's Indl. Estate, caves road

Jogeshwari (E), Mumbai- 400 060.

Ph: +91 - 22 - 28259190 / 30104500

Fax: +91 - 22 - 28265116

Email Id : [labsindia@testtex.com](mailto:labsindia@testtex.com)

Tirupur : +91-421-2228588,4218588

Noida : +91-120-4359190

Ahmedabad : +91-9601089097

Hongkong : +852-31623191

[labsindiatirupur@testtex.com](mailto:labsindiatirupur@testtex.com)

[labsindianoida@testtex.com](mailto:labsindianoida@testtex.com)

[labsindiaahmedabad@testtex.com](mailto:labsindiaahmedabad@testtex.com)

[labhk@testtex.com](mailto:labhk@testtex.com)

[www.testtex.com](http://www.testtex.com)

Tested samples will be retained for 30 days after issue of test report unless otherwise agreed with the customer.  
Testing Textiles, Leather Products, Footwear, Water, Food, Packaging Material, Construction Materials & Consumer Goods

TTI/REC30/TR/TOYS

TEST REPORT NO : MUMOT212200759

DATE : 07.06.2021

LOCATION : MUMBAI  
Page : 8 of 8

**TESTED SAMPLE IMAGE**

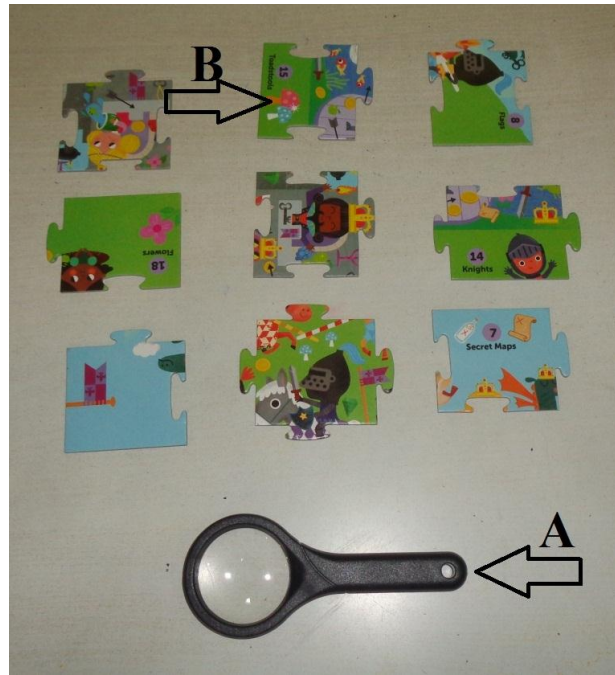

-----END OF TEST REPORT-----

**Testtex India Laboratories Pvt. Ltd.**

H.O. & CENTRAL LABORATORY:

301-304, Premson's Indl. Estate, caves road  
Jogeshwari (E), Mumbai- 400 060.

Ph: +91 - 22 - 28259190 / 30104500

Fax: +91 - 22 - 28265116

Email Id : [labsindia@testtex.com](mailto:labsindia@testtex.com)

Tirupur : +91-421-2228588,4218588

Noida : +91-120-4359190

Ahmedabad : +91-9601089097

Hongkong : +852-31623191

[labsindiatirupur@testtex.com](mailto:labsindiatirupur@testtex.com)

[labsindianoida@testtex.com](mailto:labsindianoida@testtex.com)

[labsindiaahmedabad@testtex.com](mailto:labsindiaahmedabad@testtex.com)

[labhk@testtex.com](mailto:labhk@testtex.com)

[www.testtex.com](http://www.testtex.com)

Tested samples will be retained for 30 days after issue of test report unless otherwise agreed with the customer.  
Testing Textiles, Leather Products, Footwear, Water, Food, Packaging Material, Construction Materials & Consumer Goods

**TTI/REC30/TR/TOYS**